



## Multi-stage Centrifugal Blowers, Exhausters And Gas Boosters

The design of this range of centrifugal machines allows construction with up to eight stages to handle volumes between 50 m<sup>3</sup>/hr and 5000 m<sup>3</sup>/hr, with pressures up to 1030 mbarg and vacuums to 770 mbarg.

These machines can run continuously, even under high turndown conditions, and are capable of handling a variety of gases free from oil contamination. Operating efficiently and reliably without surge, with the only maintenance required being occasional re-greasing of the bearings.

The interstage casings and housings are of aluminium construction, and the aluminium impellers are designed with backward curved vanes. Impellers are precision built and balanced to produce low torque and vibration characteristics delivering cool, pulsation free gas. Special features such as treated internals, stainless steel shaft and gas seals are provided when handling aggressive gases to ensure trouble free running and gas tightness. Machines can be supplied either bare shaft, a basic unit complete with motor or as a complete package to comply with IGE/UP/2 and customers specific requirements.

Compliant to : IGE / IP / 2  
ATEX DIRECTIVE  
MACHINERY DIRECTIVE : 2007  
BSEN 8487 : 2007

## Model 90-220

**Vacuum Pump:**  
Central Vacuum Systems

**Air/Gas Compressors:**  
Aeration  
Burners

**Gas Boosters:**  
Burners (Gas)  
Gas Engines  
Waste Gas Burners

- High Efficiency
- Low Noise Level
- Vibration Free Running
- Easy Maintenance
- Long Life

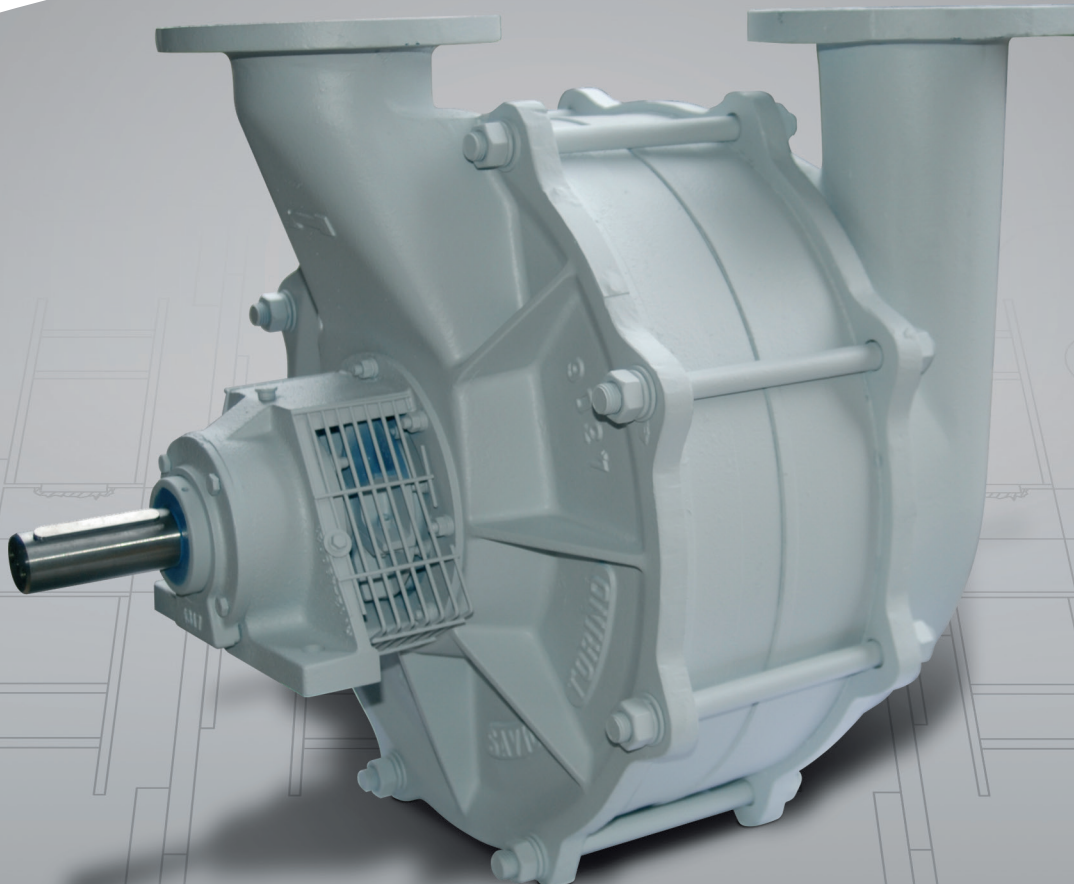

# Dimensions & Performances

## 90 SERIES

Stages	A	B	C	D	WT 1	WT 2
3	347	209	870	970	75	255
4	413	275	870	970	86	265
5	479	341	870	970	98	280
6	545	407	870	970	110	330
7	611	473	1000	1100	122	470
8	677	539	1000	1100	134	485

Weight (1) (kgs) for bareshaft models.  
Weight (2) (kgs) max. for motorised units

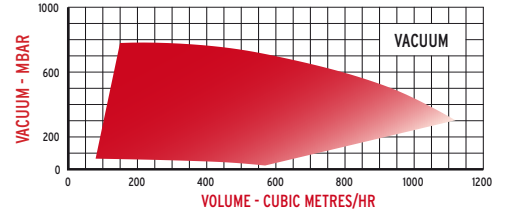
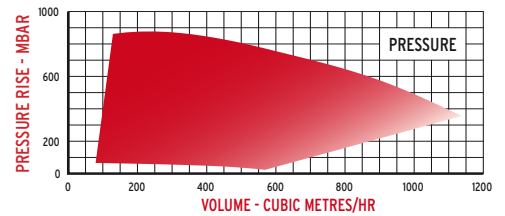
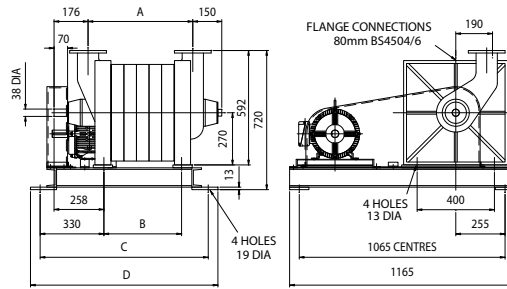

## 125 SERIES

Stages	A	B	C	D	WT 1	WT 2
3	394	575	790	890	155	655
4	477	658	873	973	177	680
5	560	741	956	1056	200	760
6	643	824	1039	1139	223	785
7	726	907	1122	1222	245	960
8	809	990	1205	1305	268	985

Weight (1) (kgs) for bareshaft models.  
Weight (2) (kgs) max. for motorised units

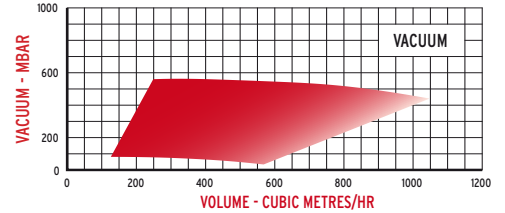
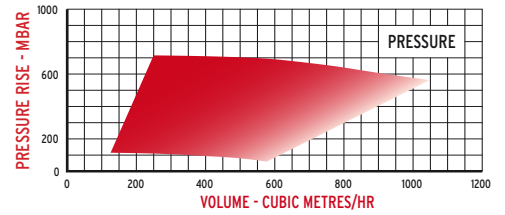
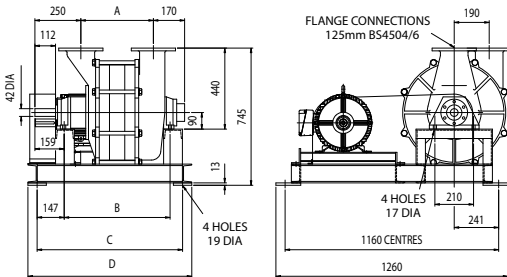

## 160 SERIES

Stages	A	B	C	D	WT 1	WT 2
3	475	760	1227	1327	260	880
4	585	870	1337	1437	305	1080
5	695	980	1447	1547	346	1220
6	805	1090	1557	1657	386	1405
7	914	1200	1666	1766	440	1465
8	1024	1310	1776	1876	480	1720

Weight (1) (kgs) for bareshaft models.  
Weight (2) (kgs) max. for motorised units

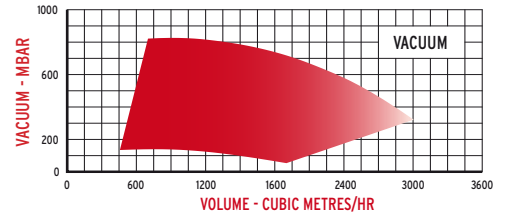
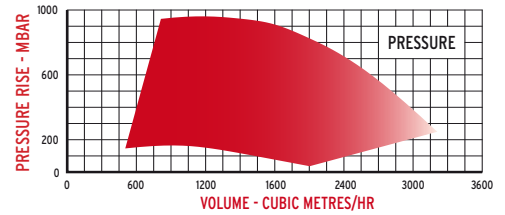
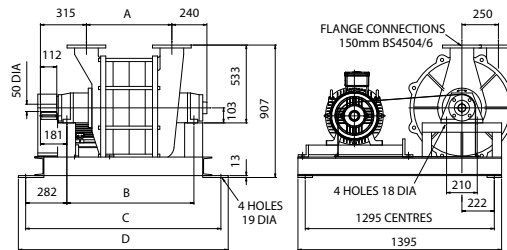

## 220 SERIES

Stages	A	B	C	D	WT 1	WT 2
3	586	866	1441	1541	300	1240
4	720	1000	1575	1675	400	1490
5	854	1134	1709	1809	500	1800
6	988	1268	1843	1943	600	2010
7	1122	1402	1977	2077	700	2320
8	1256	1536	2111	2211	800	2430

Weight (1) (kgs) for bareshaft models.  
Weight (2) (kgs) max. for motorised units

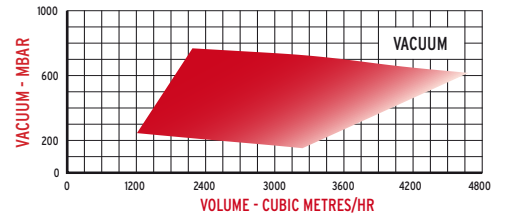
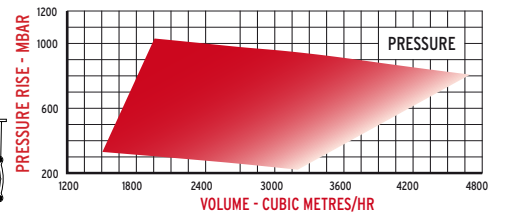
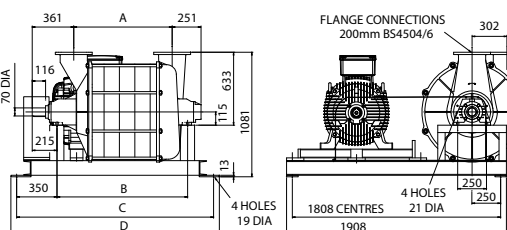

Whilst the details contained in this leaflet are representative of the machines, the actual products may differ from the illustrations due to improvements in design. Certified copies and performance curves will be supplied on request.